

THE LOFT·2

D O W N T O W N L I V I N G



Overview

This spectacular 35-story tower, designed by the award-winning architectural firm Cohen & Freedman, offers magnificent water and city views of Biscayne Bay, the Port of Miami and the night-lights of Downtown Miami. The stunning contemporary two-story lobby, with impeccable finishing's and high-speed elevators, gives way to a lush courtyard area and refreshing tropical lap pool. Residents and guests enjoy use of an elegant multi-function club room equipped with a state-of-the-art entertainment center, 35th floor fitness center complete with fully amenitized men's and women's locker rooms and a serene landscaped rooftop retreat with heated swimming pool, soothing spa and lava rock sauna. There is also 24-hour concierge and valet service.

A ONE-OF-A-KIND TOWER

Spectacular 35-story tower, designed by the award-winning architectural firm Cohen & Freedman.

Stunning two-story entrance lobby, highlighted with impeccable finishings and high-speed elevators.

Dynamic urban view-throughs from the cool contemporary lobby and lush courtyard area to the refreshing tropical lap pool.

Magnificent water and city views of Biscayne Bay, the Port of Miami and the night-lights of Downtown Miami.

Comfortably elegant multi-function club room equipped with state-of-the-art entertainment center.

Comprehensive 35th floor fitness center, overlooking world-class city views and featuring the newest strength and cardiovascular equipment.

Convenient, fully amenitized men's and women's locker rooms.

Serene landscaped roof deck retreat, with heated swimming pool, soothing spa, and lava rock sauna.

On-site, attentive 24-hour concierge and valet service to cater to your needs.

Gated garage parking.

24-hour controlled access system.

EXCEPTIONAL RESIDENCES

The hi-tech conveniences of an advanced technology "Smart Building," pre-wired for high-speed internet and cable TV access.

Expanses of tinted, energy-efficient and impact-resistant sliding glass doors and windows.

Energy-efficient air conditioning and heating system.

Lofty 10' ceiling heights (soaring to 16' in penthouses).

Move-in ready, with designer look loft-style floors.

FABULOUS KITCHENS

Cutting edge culinary centers detailed with today's most-desired features.

Imported high-design Italian cabinetry.

Elegant terrazzo countertop with matching backsplash.

Contemporary "undermount" stainless steel double sink.

Chic, energy-efficient stainless steel appliances including:

-Side-by-side refrigerator/freezer

-Self-cleaning electric range with ceramic glass cook top



www.CondoAge.com

1.800.207.8648

- Multi-cycle, pot-scrubbing dishwasher
- Built-in microwave

SOPHISTICATED BATHS

High gloss white Italian cabinetry with high-style contemporary stainless steel door handles and drawer pulls.

Gleaming marble countertops with matching backsplash.

Euro-design white drop-in sink with designer single-lever faucet.

Floors and wet walls clad in imported designer tile.

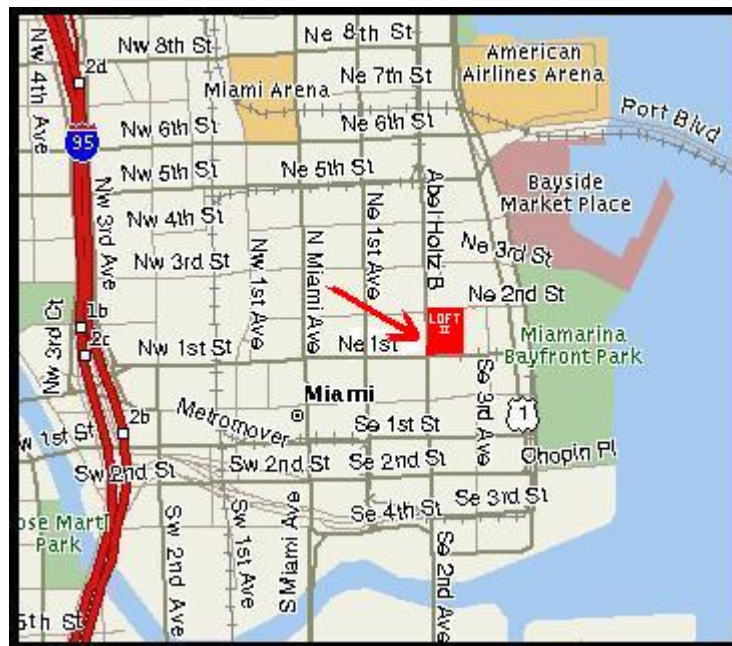

www.CondoAge.com

1.800.207.8648



Unit A1
 1 Bedroom, 1 Bath
 Under A/C
 620 sq. ft.
 57.60m²



Unit A2
 1 Bedroom, 1 Bath
 Under A/C
 646 sq. ft.
 60.02 m2

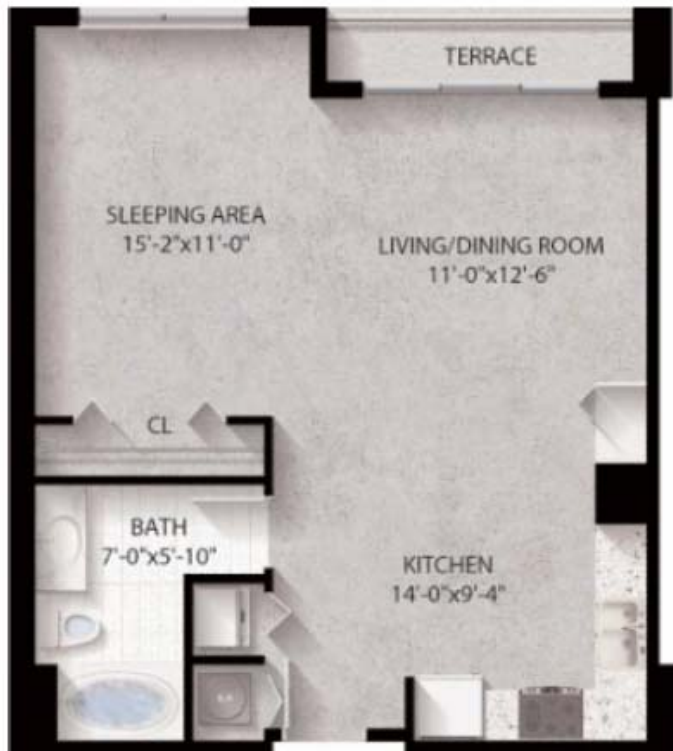

Unit A3
 1 Bedroom, 1 Bath
 Under A/C
 651 sq. ft.
 60.48 m2



Unit A4
 1 Bedroom, 1 Bath
 Under A/C
 665 sq. ft.
 61.78m²



Unit B1
 2 Bedroom, 2 Bath
 Under A/C
 1010 sq. ft.
 93.83m²



Unit B2
 2 Bedroom, 2 Bath
 Under A/C
 1041 sq. ft.
 96.71m2



Unit B3
 2 Bedroom, 2 Bath
 Under A/C
 1153 sq. ft.
 107.12m2